

SENTRIGARD SL 175, 24 GA., 17 3/4" WIDE LOAD TABLE OVER 22 GA. STEEL DECK



SENTRIGARD
METAL ROOFING SYSTEMS

Buildings having a Roof Mean Height \leq 20'-0"; Roof Slope: 2"/12" -6"/12" Gable or Hip Roof
Wind Speeds 140-180 mph, Exp C, Risk Category II, Enclosed Bldg. based on FLORIDA BUILDING CODE 2010

SENTRIGARD SL 175, 24 GA. SNAP LOCK, 17 3/4" WIDE, CLIP SPACING							
ZONE	FASTENER	SUBSTRATE	WIND SPEED ZONE				
			140	150	160	170	180
			ON CENTER SPACING	ON CENTER SPACING	ON CENTER SPACING	ON CENTER SPACING	ON CENTER SPACING
ZONE 1	(2) #14-13	22 GA. STEEL DECK	24"	24"	24"	24"	24"
ZONE 2	(2) #14-13	22 GA. STEEL DECK	12"	12"	12"	12"	12"
ZONE 3	(2) #14-13	22 GA. STEEL DECK	6"	6"	6"	6"	6"

- 1) PANEL DESCRIPTION: 1.75" SNAP LOCK, MIN. 24 GA. MSG COATED STEEL, 17 3/4" MAX WIDTH, SNAP SEAM.
- 2) PANEL FASTENER: (2) #14-13 DEK FAST PER CLIP.
- 3) PANEL CLIP: 20 GA. 2 1/4" LONG FIXED CLIP
- 4) MAXIMUM ALLOWABLE PANEL UPLIFT PRESSURE: 71.0 @ 24" O.C., 108.5 PSF @ 6" O.C. PRESSURE BASED ON UL 580/UL 1897 TESTING BY FORCE ENGINEERING TEST REPORT #72-0271T-07A-C.
- 5) SUBSTRATE: MIN. 22 GA. STEEL DECK. MUST BE DESIGNED IN ACCORDANCE WITH FBC 2010.
- 6) PANEL ROLLFORMER: SCHLEBACH QUADRO-PLUS ROLLFORMER BY METALFORMING, INC.
- 7) LOAD TABLE BASED ON WIND PRESSURES CALCULATED PER ASCE 7-10 ($K_d = 0.85$) MULTIPLIED BY 0.6 PER FBC 2010, SECTION 1609.1.5.
- 8) LOAD TABLE DOES NOT INCLUDE OVERHANG ZONES

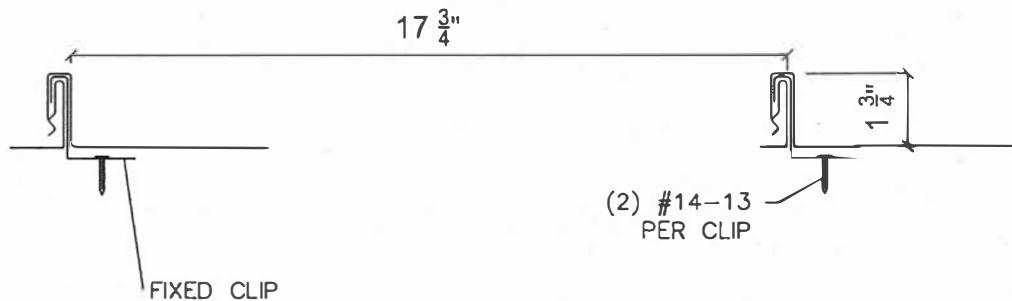

State of Florida
C.O.A.
26778

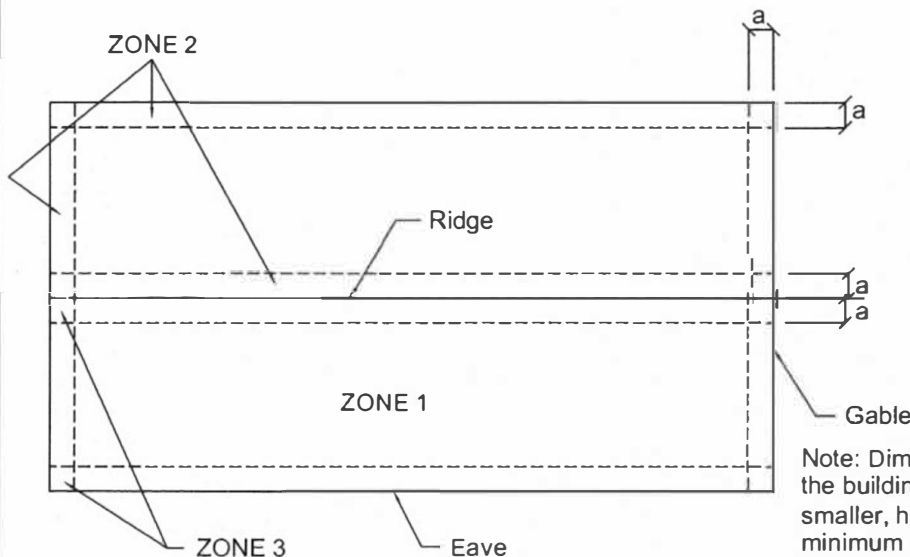

JAN 03 2012

Note: Dimension (a) is defined as 10% of the minimum width of the building or 40% of the mean height of the roof, whichever is smaller, however, (a) cannot be less than either 4% of the minimum width of the building or 3 feet.